



Church Hill, Royston, S71 4NG

Offers In Region Of £174,950

3 1 2



- TERRACE PROPERTY
- WELL PRESENTED THROUGHOUT
- OFF STREET PARKING
- NO ONWARDS VENDOR CHAIN
- CLOSE TO LOCAL SCHOOLS
- THREE BEDROOMS
- DECIEVINGLY SPACIOUS
- LARGE EXTENDED PLOT WITH PRIVATE GARDEN
- WELL REGARDED LOCATION
- EXCELLENT TRANSPORT LINKS





Ground Floor

Approx. 42.8 sq. metres (460.5 sq. feet)

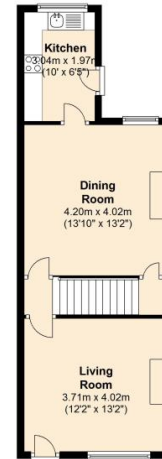

First Floor

Approx. 36.6 sq. metres (394.0 sq. feet)

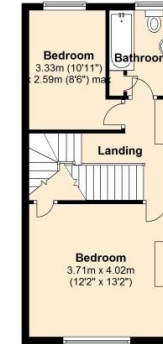

Second Floor

Approx. 19.0 sq. metres (204.9 sq. feet)

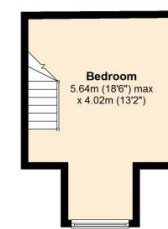

Total area: approx. 98.4 sq. metres (1059.5 sq. feet)

This floor plan is for illustrative purposes only and is not to scale. Where measurements are shown, these are approximate and should not be relied upon. Total square area includes the entirety of the property and any outbuildings/garages. Sanitary ware and kitchen fittings are representative only and approximate to actual position, shape and style. No liability is accepted in respect of any consequential loss arising from the use of this plan. Reproduced under licence from Evolve Partnership Limited. All rights reserved. Plan produced using PlanUp.

TAKE A LOOK AT THIS! EXTREMELY WELL PRESENTED THREE BEDROOM TERRACE HOME HAVING AMPLE SPACE AND FLEXIBILITY THROUGHOUT AND BEING OFFERED WITH NO VENDOR CHAIN!

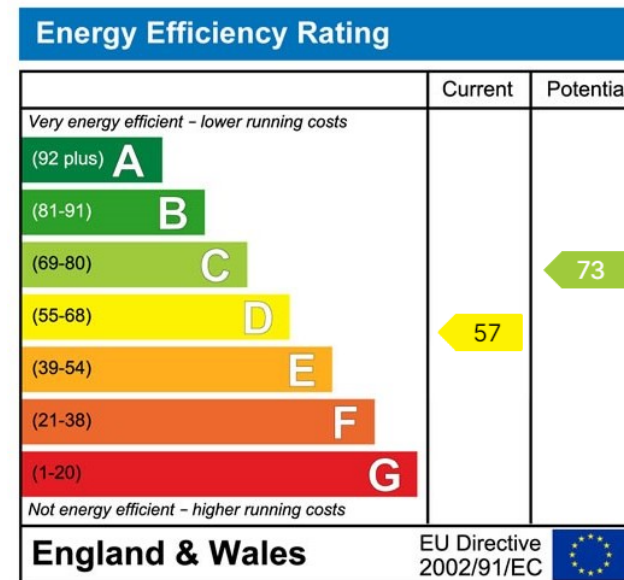

Lancasters Property Services
 Property Professionals For Over 230 Years
 Independent Estate Agents, Surveyors & Property Management
 Email: mail@lancasters-property.co.uk
 In association with Lancasters Property Management Ltd.

Lancaster House, 20 Market St.
 Penistone S36 6BZ
 Tel: (01226) 763307